

48-261

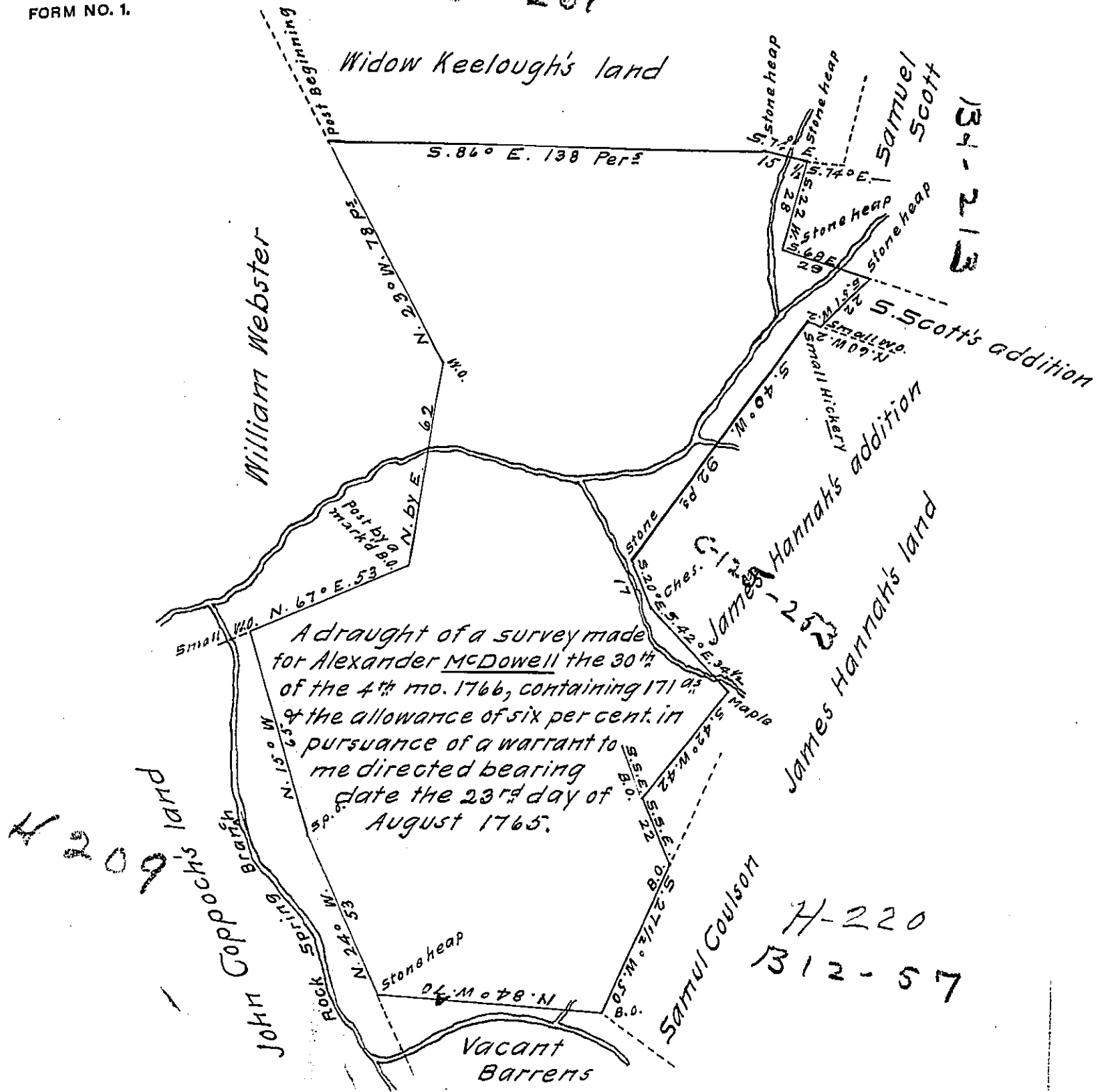

A strong attraction of iron obl. in the line A

This tract of land lyeth on the branches of Cananawango Creek in the southern part of Little Britain township Lancaster County.

Certify'd 3rd of ye 9th mo. 1766

By Geo. Churchman

To John Lukens, Surveyor General

IN TESTIMONY that the above is a copy of the original remaining on file in the Department of Internal Affairs of Pennsylvania, made conformably to an Act of Assembly approved the 16th day of February, 1833, I have hereunto set my Hand and caused the Seal of said Department to be affixed at Harrisburg, this twenty-ninth day of February 1912

Henry Howell
Secretary of Internal Affairs.